

**LAYOUT & DETAILS OF COMMON TOILET BLOCK
(GROUND & FIRST FLOOR)**

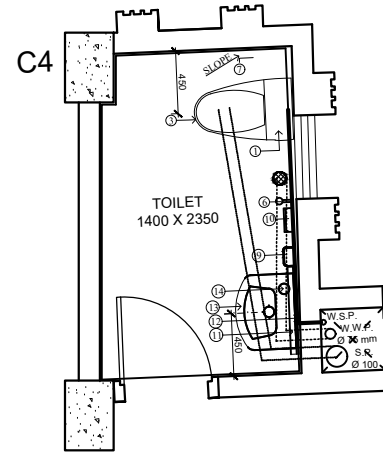

**LAYOUT & DETAILS OF
TOILET ATTACHED TO
HOD ROOM
(GROUND & FIRST FLOOR)**

NOTE:-

1. ALL DIMENSIONS ARE IN MM UNLESS OTHERWISE MENTIONED.
2. THIS DRAWING SHALL BE READ IN CONJUNCTION WITH RELEVANT DETAIL ARCHITECTURAL AND SERVICES DRAWING, ANY DISCREPANCY FOUND, SHALL BE BROUGHT TO THE NOTICE OF THE CONSULTING ARCHITECT.

LEGEND :-

(1) L. F. C	→	LOW LEVEL FLUSHING CISTERN.	+ 900
(2) W.C.	→	ORISSA PAN INDIAN TYPE W.C.	
(3) E.W.C.	→	EUROPEAN TYPE W.C.	
(4) A.F.C.	→	AUTOMATIC FLUSHING CISTERN	
(5) F.B.U.	→	FLAT BACK URINAL .	
(6) B. C.	→	BIB COCK FOR W.C.	+300
(7) F. T.	→	FLOOR TRAP (JALI).	
(8) T. R.	→	TOWEL RAIL.	+1500
(9) S. T.	→	SOAP TRAY.	+900
(10) T.P.H.	→	TOILET PAPER HOLDER	
(11) G. S.	→	GLASS SHELVE.	+1100
(12) L. M.	→	LOOKING MIRROR.	+1450
(13) W. H. B.	→	WASH HAND BASIN.	TOP LVL
(14) P. C.	→	PILLAR COCK.	+800
(15) W. S. P.	→	WATER SUPPLY PIPE	
(16) W. W. P.	→	WASTE WATER PIPE Ø 90	
(17) S. P.	→	SOIL PIPE Ø 110	
(18) S. C.	→	STOP COCK	
(19) S.P.U.	→	SQUATTING PLATE URINAL.	

0	10-07-2022	ISSUED FOR CONSTRUCTION	
REV	DATE	REVISION PARTICULARS	SIGN
WORK:-			
PROPOSED ACADEMIC BUILDING, PHASE-IV, BLOCK-II, AT ATUATIKA, RAIDONGIA, NAGAON, ASSAM FOR MAHAPURUSHA SRIMANTA SANKARADEVA VISWAVIDYALAYA (MSSV) AT H. B. ROAD, KALONGPAR, NAGAON, PIN-782001:ASSAM:INDIA			
DRAWING:-			
LAYOUT AND DETAILS OF TOILET			
PROJECT ARCHITECT:-			
INTEGRATED DESIGN FORUM			
ARCHITECT, HRIDAI KR. NATH COUNCIL OF ARCHITECTURE REGD. NO. CA/2013/24079 15, 2ND FLOOR, ABOVE MIRA MUSICAL MART, RAJGARH MAIN RODA, CHANDMARI, GUWAHATI, ASSAM. PHONE :- +91 78961 89205, +91 70024 02930 email id: hridai.dbpl@gmail.com			
DRAWN	CHECKED	DATE	SCALE
RIJUMONI	AR. HRIDAI	10-07-2022	SCALE TO FIT
DRG NO	IDF/AD-21		
REV-00			

● THE DRAWING AND DESIGN IS THE PROPERTY OF THE ARCHITECT ANY COPYRIGHT VIOLATION WILL RESULT IN PROSECUTION